



Hilton Arc de Triomphe Paris

Travel should take you places™

Restaurants & Bars

• «Le Safran» Restaurant

Refined, inventive food served in Art Deco surroundings. Le Safran has two large rooms with natural lighting and two shady terraces which can be reserved for a private function.

• Le Carré du Patio

Private space of 50 m² in the heart of the hotel conducive to more intimate dining.

• Purple Bar

A variety of snacks and a stylish range of cocktails served in a trendy setting. Enjoy the tasselled chandeliers and cosy booths of the Purple Bar while you listen to live music.

Practical information

- Currency: euro
- 7 minutes' walk from the Champs Elysées, the Arc de Triomphe and the rue du Faubourg St Honoré
- Close to railway stations: Gare Montparnasse, Gare de l'Est, Gare du Nord, Gare de Lyon & Gare d'Austerlitz
- International airports: Roissy Charles de Gaulle (30 min) and Orly (40 min)
- Transport networks: metro, regional trains, bus & tramway
- Major international event venues: Palais des Congrès, Le Bourget, Porte de Versailles, Parc des Expositions de Villepinte...

Business Centre...

1,700 m² ideal for meetings, dinners and cocktails. Natural lighting in the ground floor rooms around the Andalusian patio.

For your convenience:

- A business centre
- WIFI Internet connection
- A dedicated event service
- Leading-edge audiovisual and telecommunication facilities
- 100-space public parking building (parking fees) with direct access to the hotel

Leisure facilities

- 400 m² Mosaic Spa (10 cabins): complete, personalised care in a sensorial atmosphere
- Hydrotonic bath with massaging jet showers, hammam and sauna
- Fitness Centre with high-tech equipment

Incentive activities

- A bike ride around the city
- A night trip to the catacombs
- Cultural rally
- Treasure hunt
- Backstage in the Paris Opera house
- A tour of the Montmartre vineyards...

For bookings, call the Hilton Reservations and Customer Care Centre at 00800 444 58667 or go to hilton.com.



Hilton Arc de Triomphe Paris

Travel should take you places™

Hilton Arc de Triomphe Paris

51-57 Rue de Courcelles - 75 008 Paris

Tel. : +33 (0)1 58 36 67 00

Fax : +33 (0)1 58 36 67 77

events.parisarcdetriomphe@hilton.com

www.arcdetriompheparis.hilton.com

hilton.com

Hotel Location

An outstanding location facing the Parc Monceau, a few minutes from the Arc de Triomphe, the Champs Elysées and the shops of the Faubourg St Honoré.

30 minutes from Roissy Charles de Gaulle airport and 40 minutes from Orly airport.

Rooms

463 rooms, from 30 to 150 m², including 51 suites inspired by the greatest Art Deco designers. 41 rooms and suites have a private terrace and some have a view of the Eiffel Tower.

- King Guest Room
- Double Double Guest Room
- King Guest Room Plus
- King Deluxe Room
- King Deluxe Plus Room
- King Executive
- Double Double Executive
- King Executive Plus
- King Executive Eiffel
- Family Room
- Junior Suite
- Deluxe Suite
- Terrace Suite
- Presidential Suite

All rooms have:

- Individually controlled air-conditioning
- Minibar
- Direct-dial telephone and message service
- LCD flat screen satellite television
- Pay movies and video games
- Large individual safe
- Internet connection
- Room service
- Bathrobe and slippers

Check-In 2 p.m.

Check-Out 12 a.m.

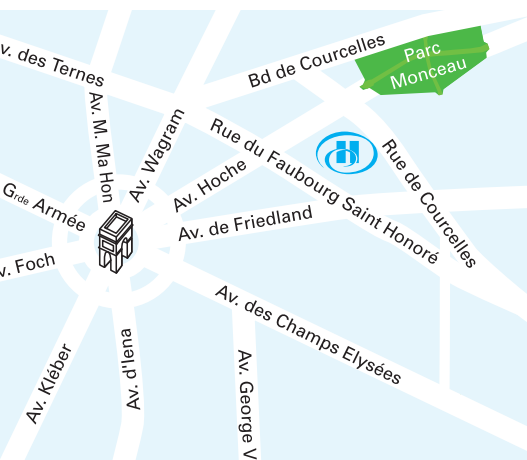



Hilton Arc de Triomphe Paris – Capacity and Plans

Rooms	Floor	Ceiling Height (m)	Dimensions (m)	Area (m ²)	Rectangle	Theatre	Classroom (3 per table)	No. of tables	U-shape	Cabaret (7 per table)	No. of tables	Banquet (10 per table)	Lunch/Dinner Cocktail	Banquet / Dance	Buffet (no dance floor)
Normandie	Lev - 1	3.7	27 x 24	648	-	550	380	127	-	252	36	480	650	350	380
Normandie 1 / 3 / 5 / 7	Lev - 1	3.7	9.71 x 8.6	84	22	45	36	12	24	28	4	40	60	-	30
Normandie 2	Lev - 1	3.7	9.71 x 6.4	62	18	45	36	12	24	28	4	40	60	-	30
Normandie 4	Lev - 1	3.7	24 x 7.4	178	-	200	90	30	-	77	11	120	150	80	90
Normandie 6	Lev - 1	3.7	9.7 x 6.4	62	18	40	30	10	24	28	4	40	60	-	30
Normandie 1+2 / 2+3	Lev - 1	3.7	15 x 9.7	146	-	110	70	23	40	56	8	90	120	60	70
Normandie 1+2+3 / 5+6+7	Lev - 1	3.7	23.6 x 9.7	230	-	200	100	33	-	84	12	140	220	90	100
Normandie 1+2+3+4	Lev - 1	3.7	24 x 17	408	-	350	210	70	-	140	20	250	340	200	210
Carré du Patio	GF	3	7.5 x 6.4	48	14	30	27	9	18	21	3	30	30	-	30
Rochambeau	GF	3	7.5 x 6.3	48	16	-	-	-	-	-	-	-	-	-	-
Lafayette	GF	3	15.3 x 6	92	26	90	54	18	36	42	6	60	80	-	50
Lafayette 1	GF	3	6.3 x 3.7	23	8	15	-	-	-	-	-	-	15	-	-
Lafayette 2	GF	3	7.7 x 6	46	14	30	27	9	18	14	2	30	30	-	-
Lafayette 3	GF	3	6.3 x 3.7	23	8	15	-	-	-	-	-	-	-	-	-
Lafayette 1+2	GF	3	11.5 x 6.3	69	20	60	36	12	30	28	4	40	50	-	30
Lafayette 2+3	GF	3	11.5 x 6.4	69	20	60	36	12	30	28	4	40	50	-	30
Liberty	GF	3	7.1 x 6	43	14	30	27	9	18	21	3	30	30	-	30
Queen Mary	GF	2.9	21.9 x 13.2	289	-	230	140	47	54	126	18	200	280	-	180
Queen Mary 1	GF	2.9	7 x 6.5	46	10	30	18	6	15	14	2	20	30	-	20
Queen Mary 2	GF	2.9	7 x 6.5	46	10	30	18	6	15	14	2	20	30	-	20
Queen Mary 3	GF	2.9	13.2 x 7.7	102	27	80	54	18	30	42	6	60	70	-	50
Queen Mary 4	GF	2.9	7 x 6.5	46	10	30	18	6	15	14	2	20	30	-	20
Queen Mary 5	GF	2.9	7 x 6.5	46	10	30	18	6	15	14	2	20	30	-	20
Queen Mary 1+2	GF	2.9	12.2 x 7	92	24	90	54	18	30	42	6	60	70	-	50
Queen Mary 1+2+3	GF	2.9	14 x 13.2	185	-	150	90	30	-	84	12	120	120	-	90
Queen Mary 4+5	GF	2.9	13.2 x 7	92	24	80	54	18	30	42	6	60	70	-	50
Queen Mary 3+4+5	GF	2.9	14.5 x 13.2	191	-	150	90	30	-	84	12	120	120	-	90
Champollion	GF	2.9	7.55 x 6.35	48	16	-	-	-	-	-	-	-	-	-	-
Provence	GF	2.9	7.45 x 6.3	47	14	19	19	8	18	-	-	-	-	-	-
Foyer Normandie	Lev - 1			300	-	-	-	-	-	-	-	250/ 200	350	-	-

For all your events, contact «Conferences & Events» at +33 (0) 1 58 36 67 22
or by e-mail: events.parisarcdetriomphe@hilton.com



Ground Floor

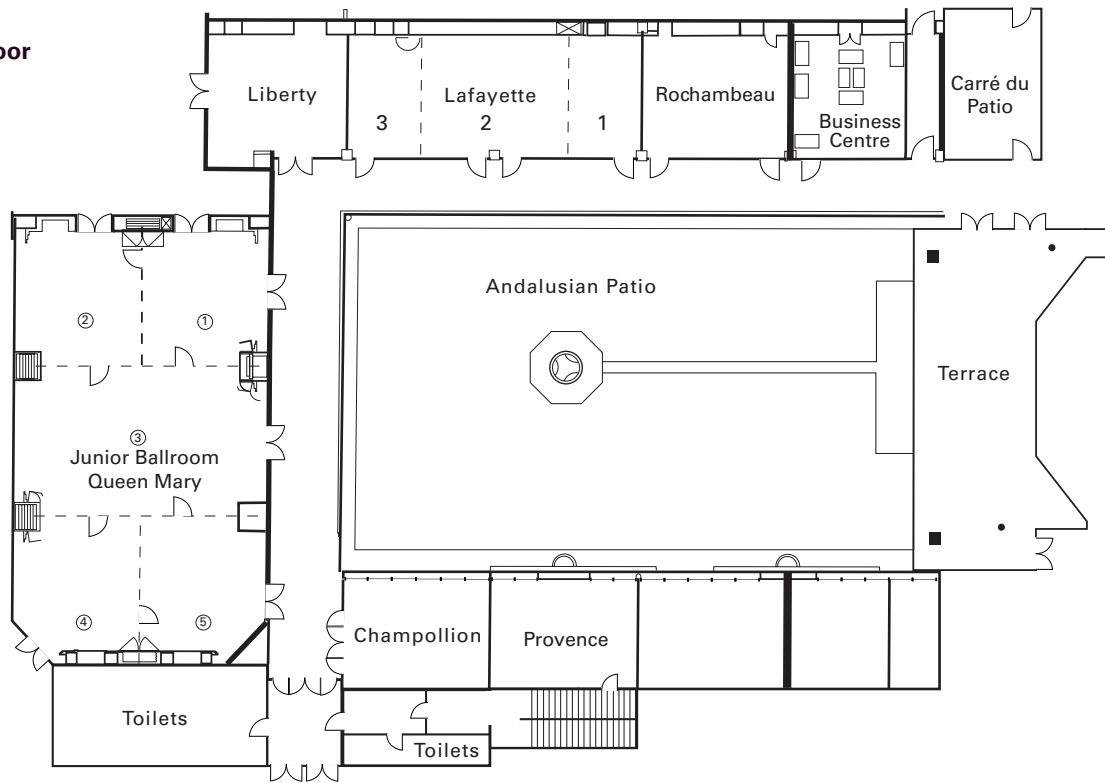

Level -1

